

AVAILABLE LAND FOR BUSINESS DEVELOPMENT AT BELFAST MUNICIPAL AIRPORT:

There currently exists at Belfast Municipal Airport one sizable parcel of land (approximately 13 acres) that is ideally suited for aeronautical use, but has been determined to not be required for future development and can potentially aid the airport financially by providing revenue through its lease or sale; known as Area E in the airport's 2008 layout plan update (see Figure M, next page).

This approximately 13-acre parcel that once served as a paved runway enjoys lower development costs than other areas at the airport, due to it being level, dry, and free of trees. The parcel is also connected via access road to the immediately adjacent to the south phase of the Belfast Airport Business Park, with easy access to utilities.

This area is well-situated for commercial aviation development, such as large corporate hangars, but the City of Belfast would potentially consider any business development proposal that would be FAA-compliant.

If you have interest in business development at Belfast Municipal Airport, please contact:

Thomas Kittredge

Airport Manager, Economic Development Director
City of Belfast
(207) 338-3370 ext. 116
economicdevelopment@cityofbelfast.org
www.cityofbelfast.org/economicdevelopment
www.cityofbelfast.org/airport

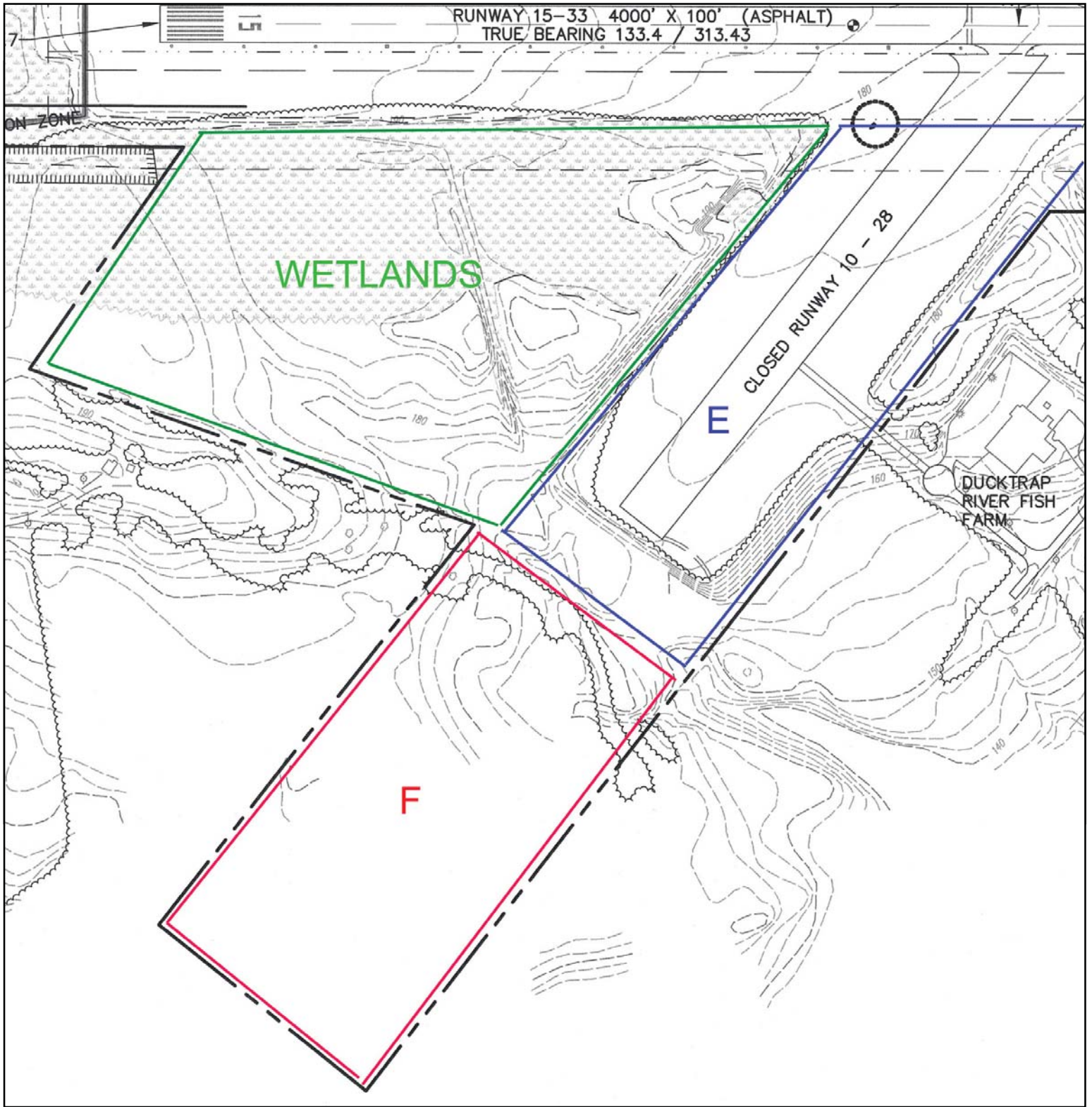

Figure M: West Quadrant Available Land

Source: Dufresne-Henry, Inc., graphic



**Lincolville Avenue
Route 52**

Downtown Belfast

U.S. Route 1

**APPROXIMATE
Airport
Boundary**

Undeveloped Closed Runway

**East
Terminal
Area**

Congress Street

**Ducktrap
River Fish Farm**

Little River Drive

